

Why WALLE?

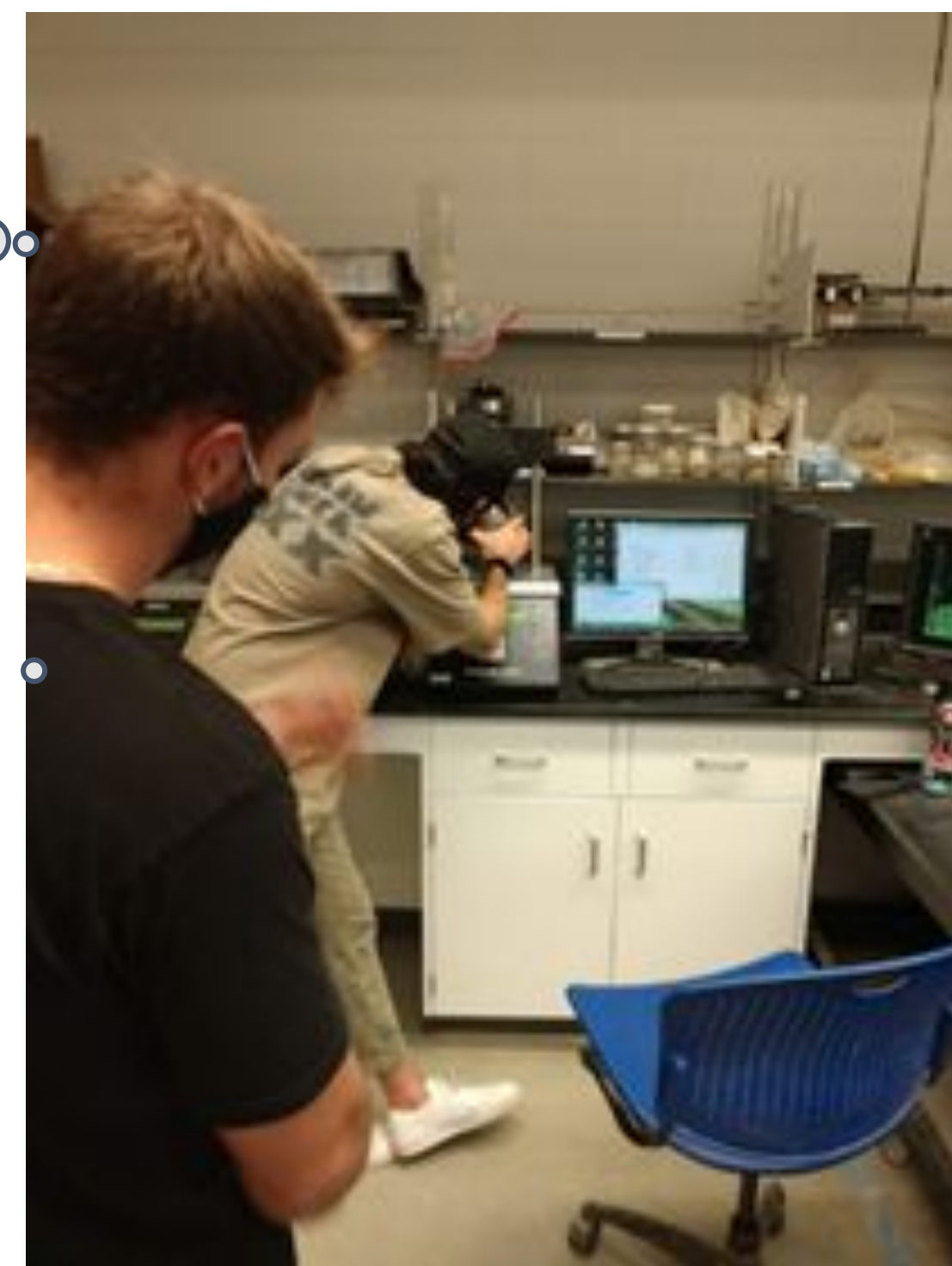

That happened too fast, I missed it!

I can't watch and take notes at the same time!

I wish I could rewind and replay this!

I can't see what's happening!

Using WALLE

Viewing a WALLE:

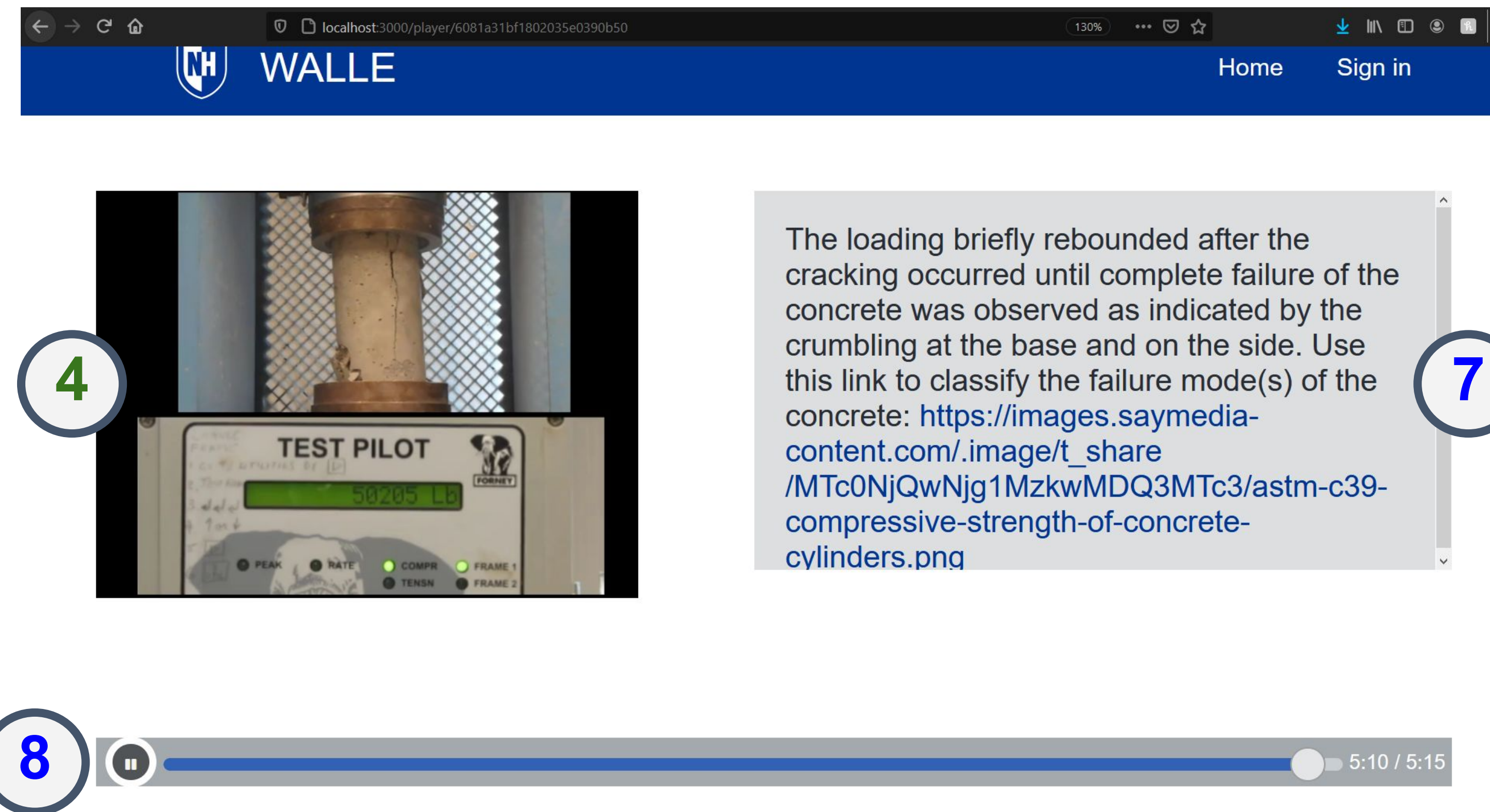

Creating a WALLE:



Editing a WALLE:

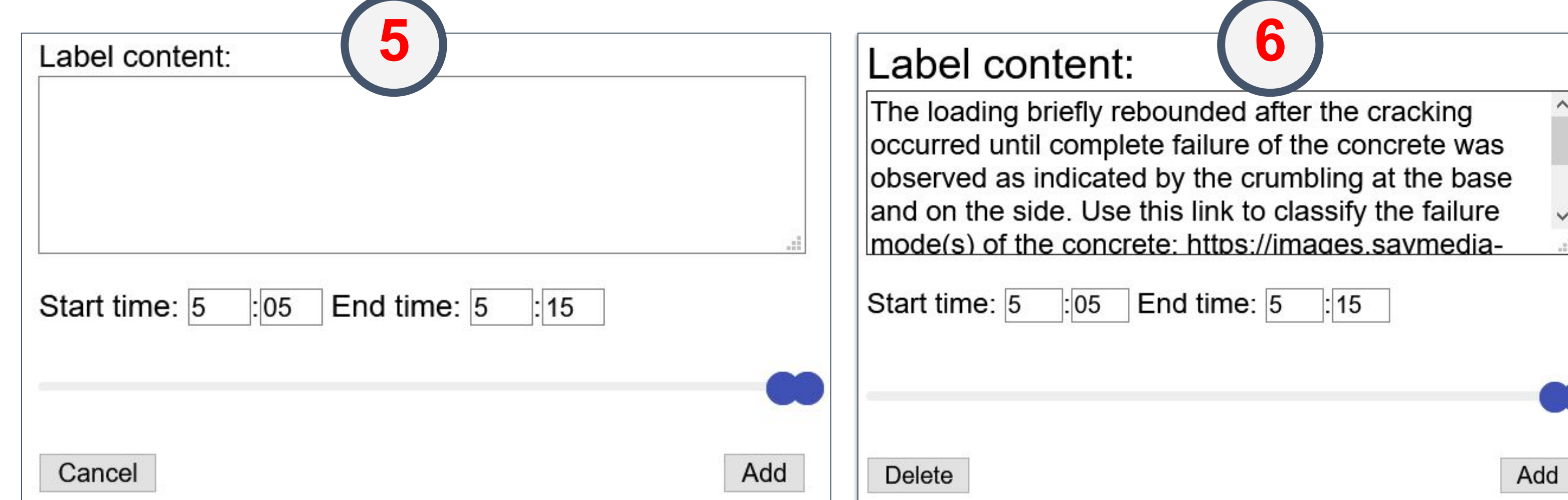

WALLE Features

Homepage:

- 1 Upload up to 2 videos
- 2 Create new WALLEs
- 3 Display/edit all WALLEs and their associated info
- 4 Merge videos when 2 videos are submitted

Editing screen:

- 5 Add new popups
 - 6 Edit an existing popup
- Submit changes

Student's screen:

- 7 Show popups synchronized with the video
- 8 Control video using timebar controls

WALLE Architecture

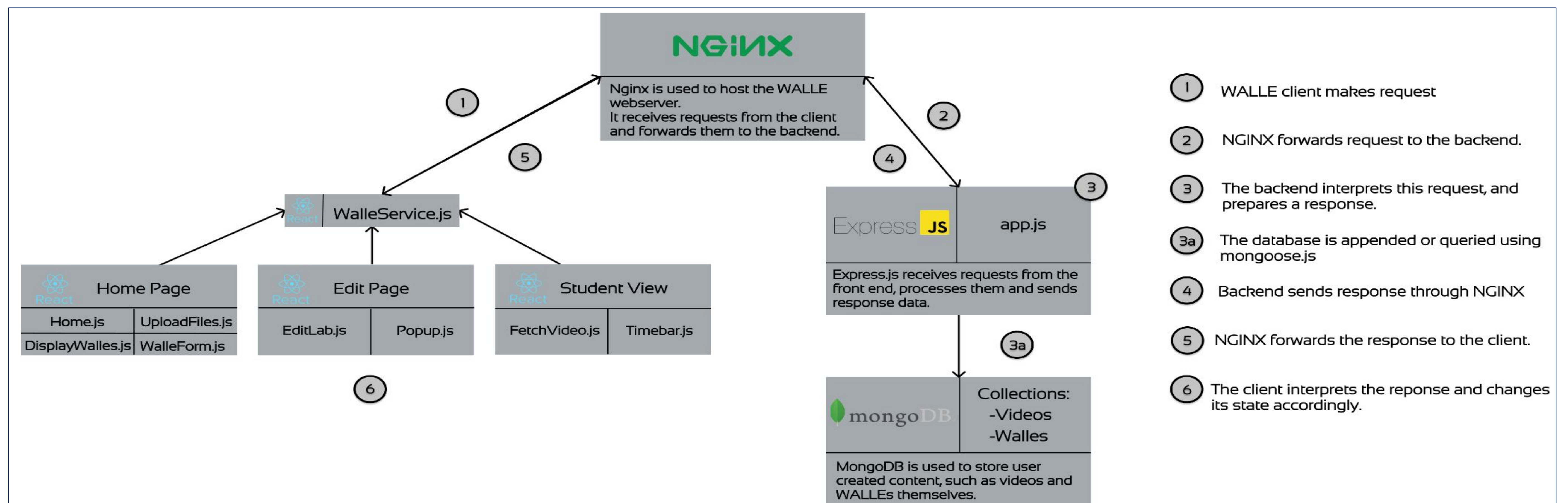

What's Next for WALLE?

Incorporate more features:

- Dynamic X-Y plot that displays data synchronized with the video.
- Measurement data window that contains static (specimen size) and dynamic (force, displacement) data
- Ability for students to change the playback speed

Strengthen backend and security:

- Back up stored data
- Add HTTPS and SSL certificates
- Manage access and administrative privileges